

Smart Lock User Manual

Model:TB-FH1

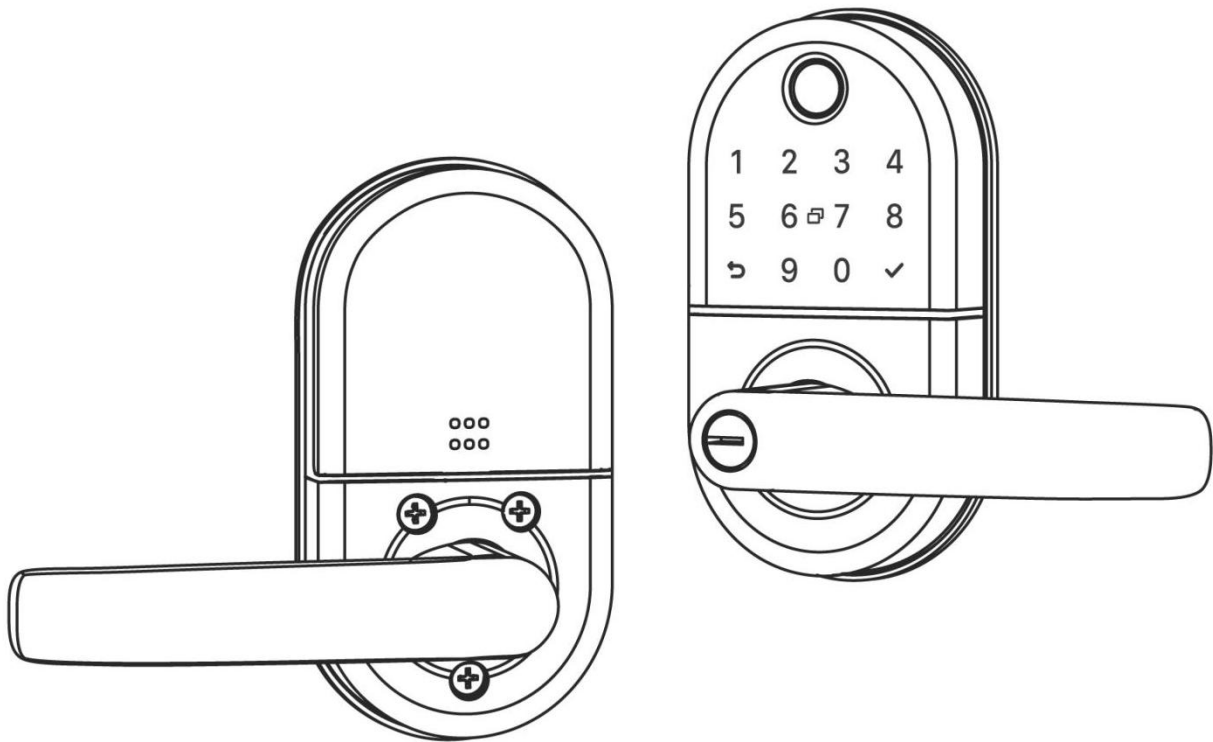

IMPORTANT NOTES

- 1.Install and test the lock with the door open to avoid being locked out.
- 2.DO NOT install the batteries before installing the lock!
- 3.Follow the instructions in sequential order!
- 4.Please must use AA Alkaline Battery and don't use Lithium Battery or Rechargeable Battery.
- 5.Please replace for the battery when low wattage alarm.
- 6.Reading this manual carefully before installation, and keep it for future reference.

1. Product Overview

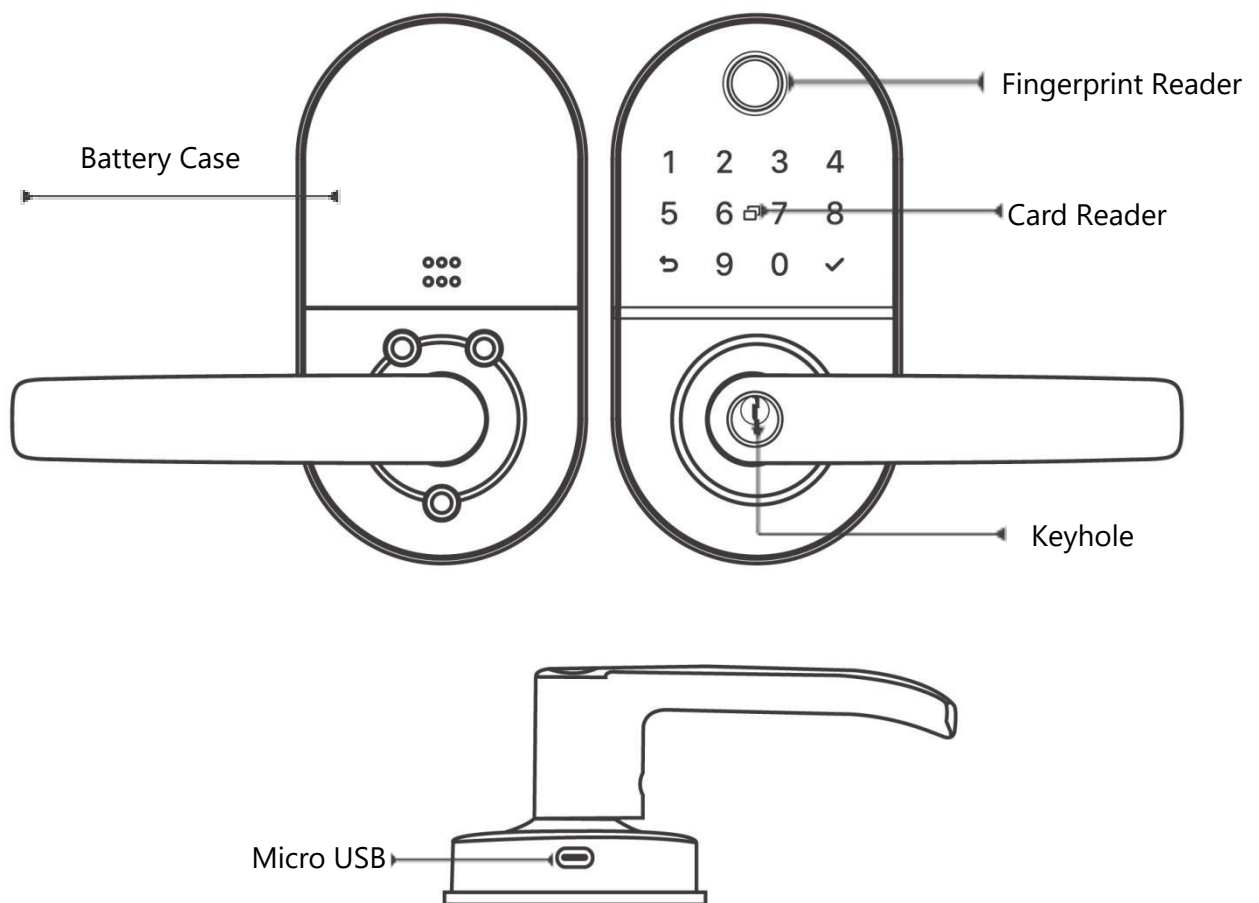

Fingerprint Reader

Used to verify your finger and unlock from outside.

Card Reader

Used to read the card and unlock from outside.

Keyhole

Used to insert key to unlock in emergency situations.

Keypad

Used to enter the password and unlock from outside.

Battery Case

Used to insert 4 AA Alkaline Batteries.

Type-C USB (5V)

Used to connect power bank to activate the lock when battery runs out.
(It can't charge the battery of lock)

2.packing List

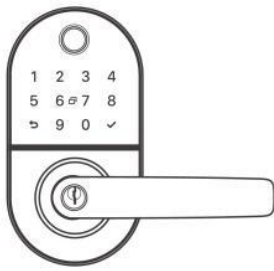

Exterior Assembly * 1

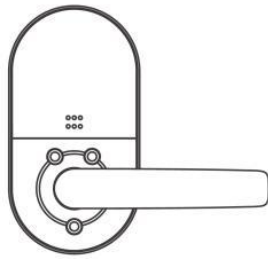

Interior Assembly * 1

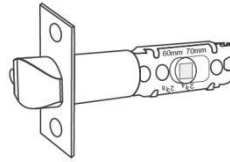

Latch*1



Rubber Plate * 2

Smart Lock User Manual
Model:H13

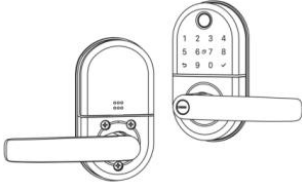

User Manual * 1

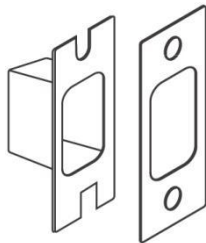

Strike & Strike Box * 1

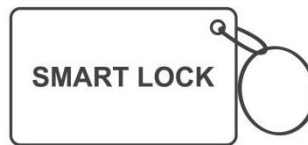

IC Card *3



Mechanical Key* 2



Screw A *4



Pin*1

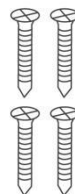

Screw B* 4



L Shape Allen Wrench * 1



Positioning Column *2

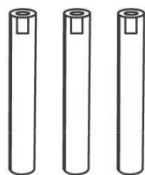

Screw Casing*3

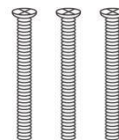

Screw C *3



Square Shaft*1

3.Introduction

3.1.Lock structure

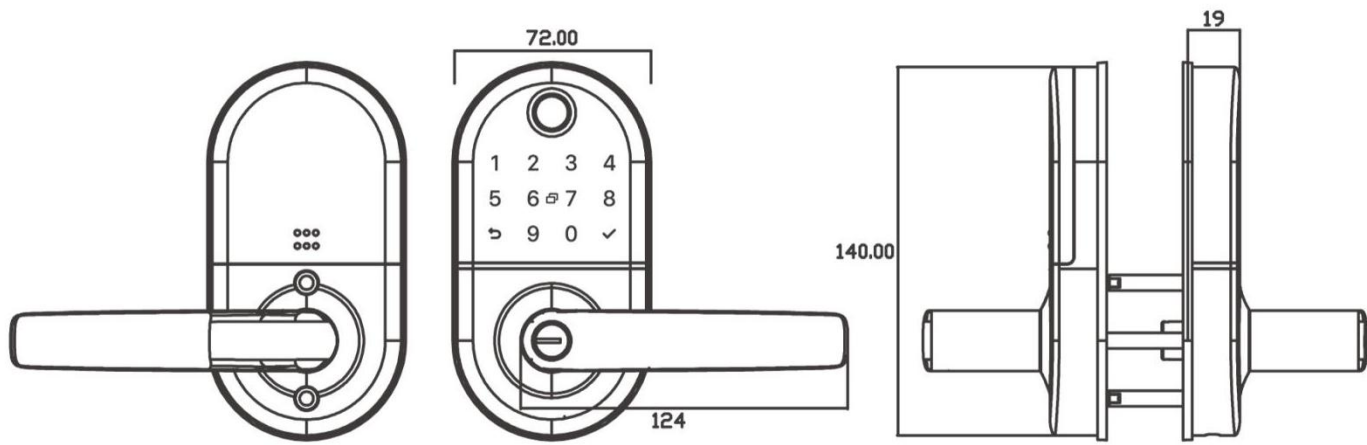

3.2.Specifications

Suitable for Models	TB-FH1	Doors Applicable	Aluminum door Wooden door
Materials	Aluminum alloy	Working Voltage	6V/2*CR123A
Lock Weight	2KG	Door Thickness to Fit	35-65mm
Unlocking Way	Bluetooth Fingerprint(option) Password Card Mechanical key Gateway(option)	Data Capacity	Fingerprint: 50 Password: 50 Card: 50
Color	Silver Black	Working Temperature	-10°C-55°C
Low Wattage Alarm	Less than 4.8V	Working Humidity	0-95%

4.Installation

4.1Adjust Latch Backset Length

Measure your door backset, then adjust to the corresponding latch length.

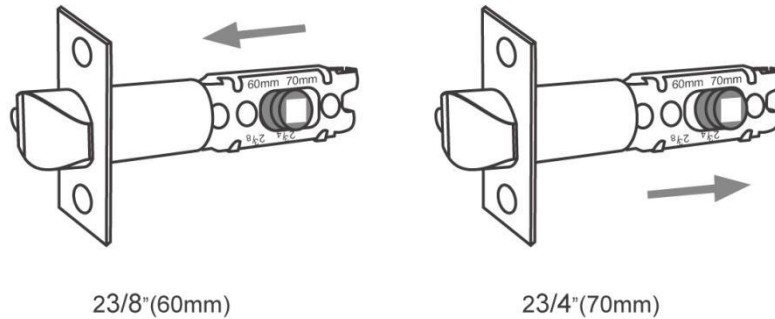

4.2Adjust the Handles Direction

Notice: Adjust the handle according to the direction you open the door.

For Exterior Assembly:

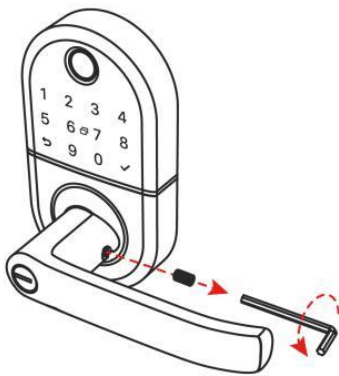

1.Loosen the screw with

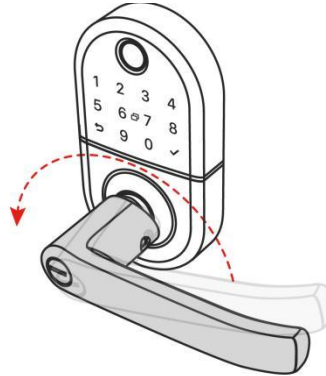

2.Adjust the door handle



3.Tighten the screws after adjusting the

For Interior Assembly:

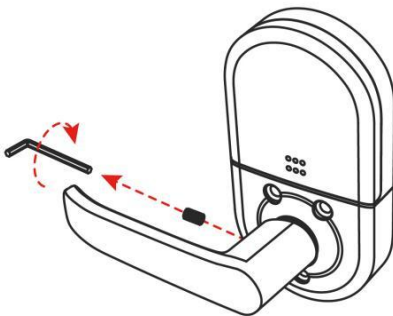

1.Loosen the screw

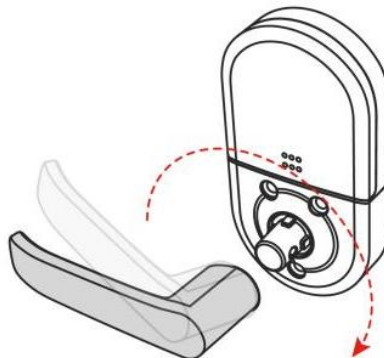

2.Adjust the door handle

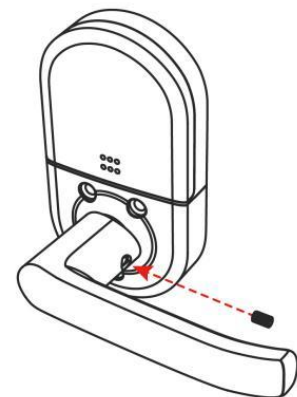

3.Tighten the screws after adjusting the

4.3. Installation Diagram

Step 1 Install Mortise

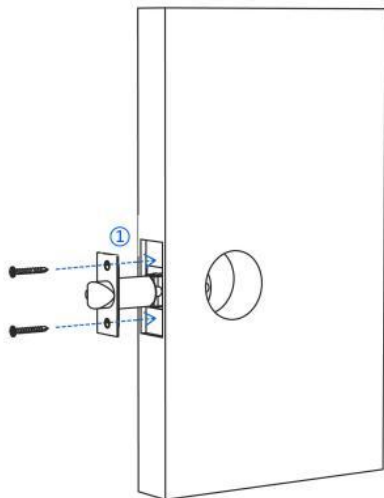

Install Mortise into door with Screw B and fix it.
(Refer to step ①)

Step 2 Install Exterior Assembly

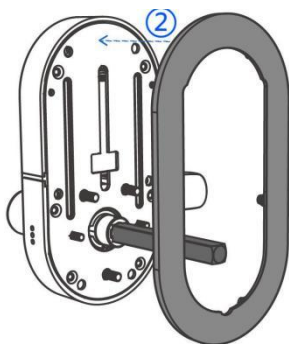

1.Install the waterproof rubber plate to exterior assembly. (Refer to step ②)

2.Install square shaft into spindle hub. (Refer to step ③)

3.Install 2 positioning columns. (Refer to step ④)

4.Install exterior assembly with 3 screw casings. (Refer to step ⑤)

5.Install exterior assembly.

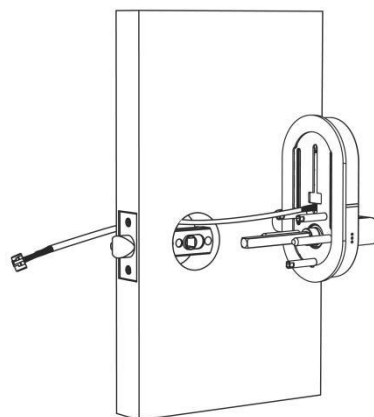
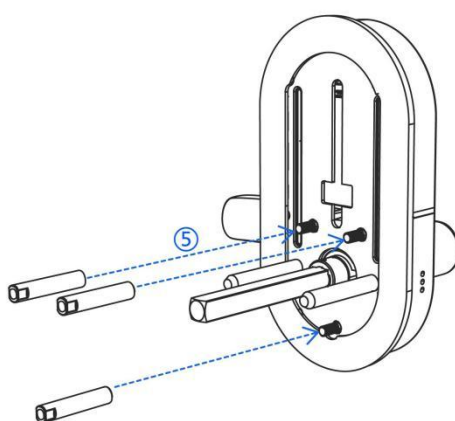
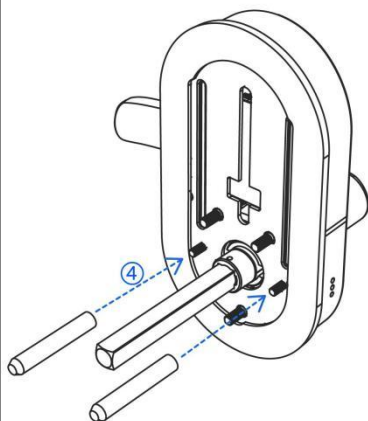

Step 3 Install Interior Assembly

1. Install the waterproof rubber plate. (Refer to step ⑥)
2. Connect the wire. (Refer to step 7)
3. Secure exterior assembly with screw C. (Refer to step ⑧)

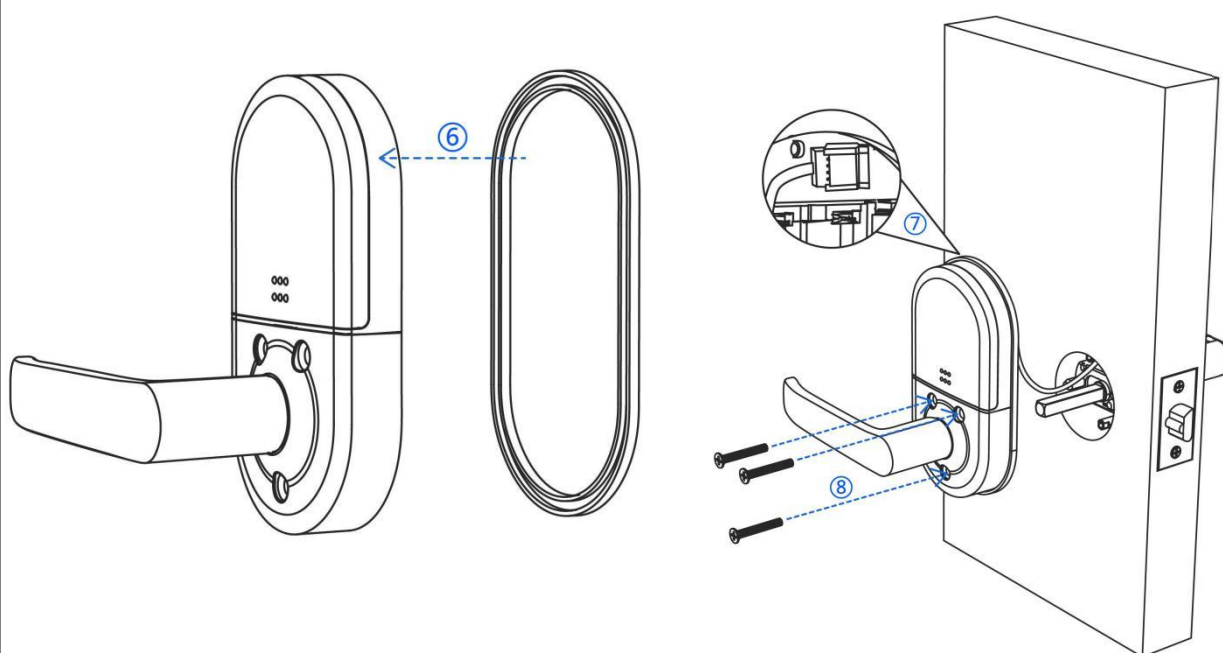

Step 4 Install batteries

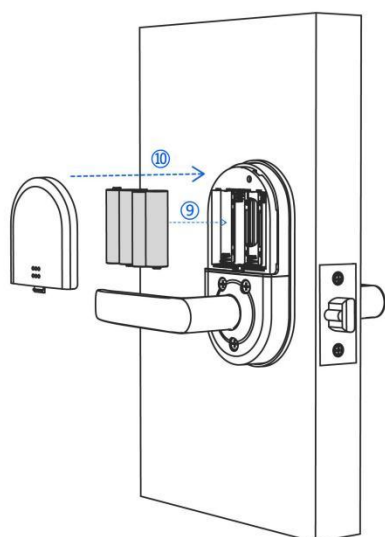

1. Insert 4 AA alkaline batteries. (Refer to step ⑨)
2. Install the battery cover. Refer to step ⑩)
3. Installation Complete.

5.System Initialization

Open the cover plate of the front panel ,long press the "Reset" button on the back panel for 5s,and the initialization is complete .



6. App operation

6.1.Download

You can search for [Smart life] in various app stores or scan the QR code above to download



6.2.Register

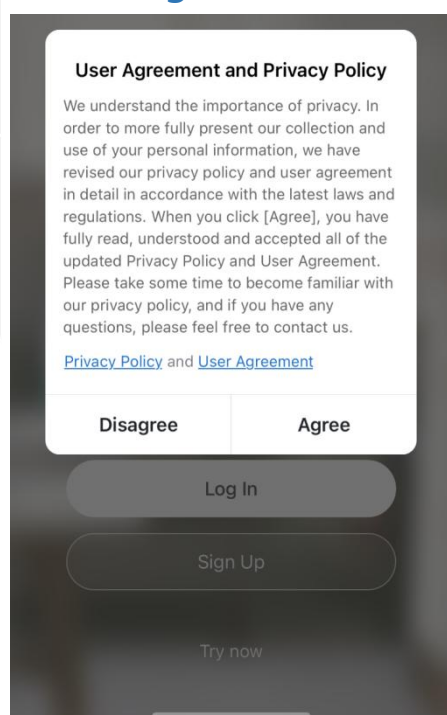

1.Click "Sign Up"and read the Privacy Policy after it pops up. Click "Agree" and enter the registration page.

2.You can use email or mobile number as your account to register. The country/region of the APP will be the same as the phone's. You can also change it by yourself when registering. (You cannot change the country/region after the registration). Enter mobile number/email and click"Get Verification Code".

3.Enter the verification code and turn to the password setting page. Set your password as required and click "Done".

6.3.Registration and Login Your Account

(1) login with an existing account

① If you already have an account, choose "Register with Existing Account" and enter the log in page.

② The system will automatically locate the current country/region you are in. Or you can choose the country/region by yourself.

(2) Register a new account

Register a new account with your mobile number or email.

6.4.Pair the lock in the APP

6.4.1. Add Lock

1. Tap Add Device on the Home page or "+" in the upper right corner of the page to go to the Add Device page. (Refer to picture ①)

2. Click on the "Sensors" category on the left, Find the "Sensor (Bluetooth)". (Refer to picture ②)

3. The lock needs to be added by the app after entering the add mode. Generally, a lock that has not been added, as long as the lock keyboard is touched, it will enter the add mode. (Refer to picture ③)

4. After searching for the door lock, click "Done" to add. (Refer to picture ④)

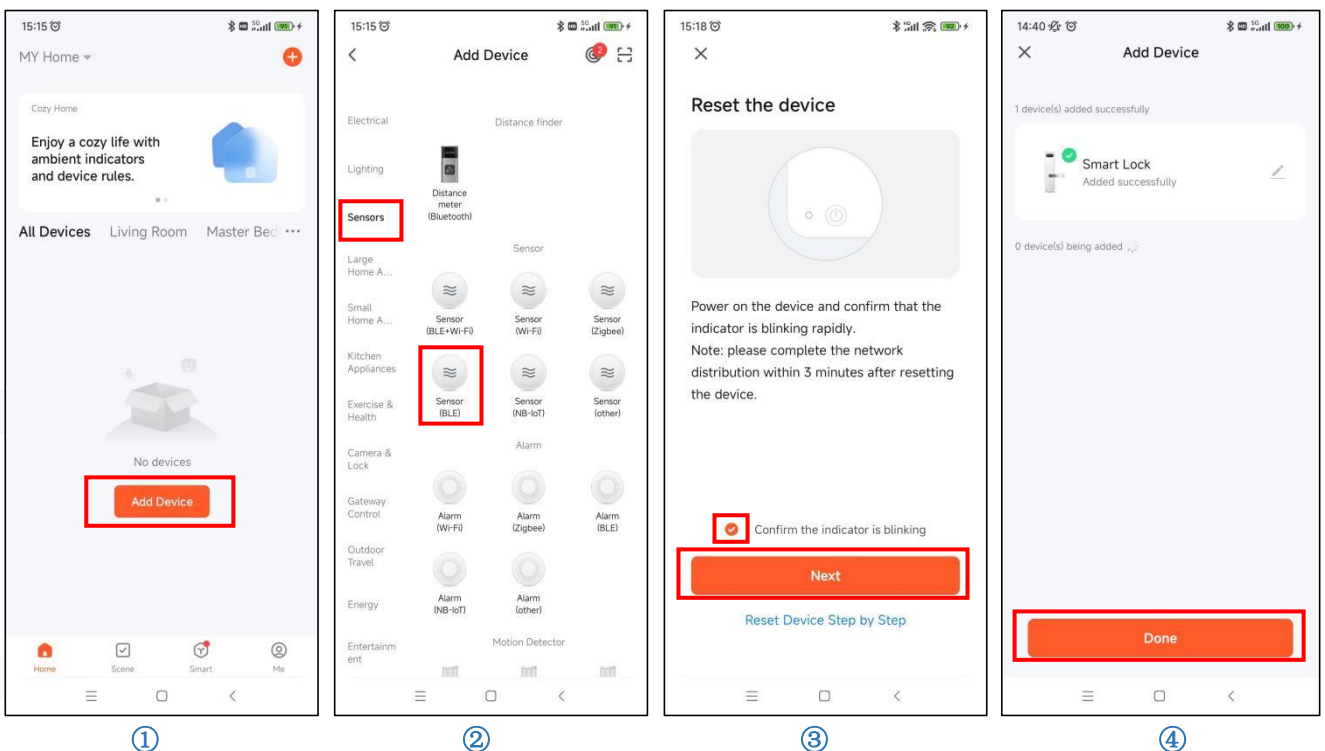

6.4.2. Interface introduce

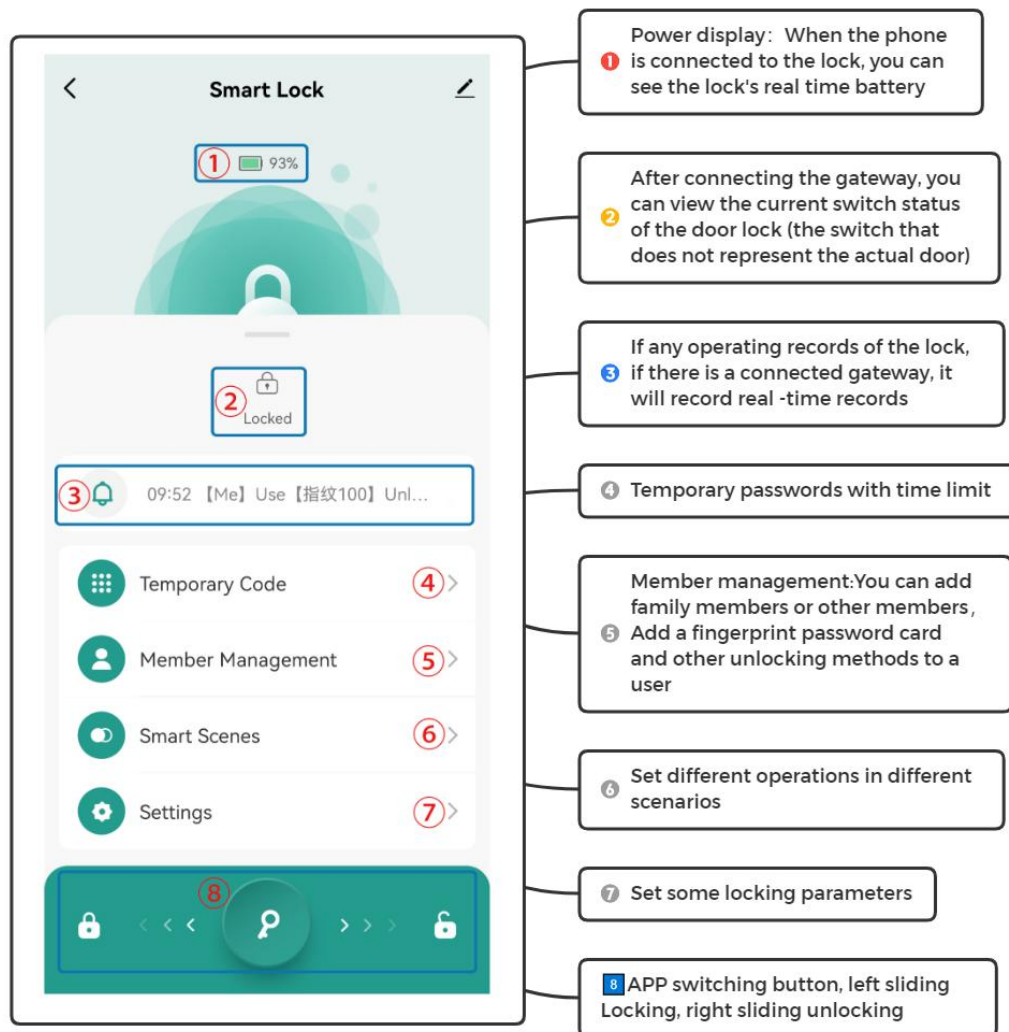

6.5 Add user

6.5.1. Members and management

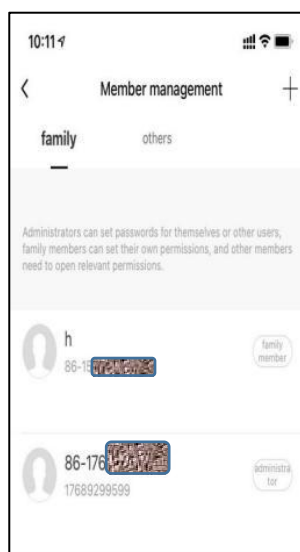

a) Two different kinds of members

1. Family members-this type of member is consistent with the users in the family group in the app; when a new user is added to the family group in the app, one more family member will appear in the door lock member.
Note: Delete family members can only be operated in the family member management of the app.

2. Other members-refers to users who only appear in the door lock, not users in the app family group. Adding or deleting such users will not affect the members of the app family group.

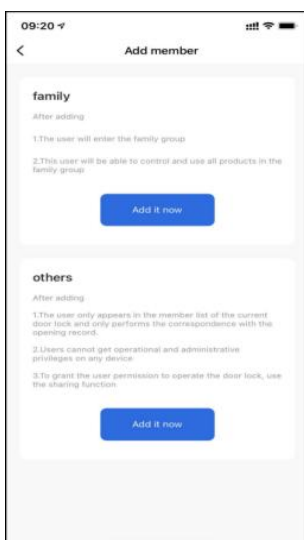

b)Family members management and Other members management

- 1.Validity period: Once added, the family member's use time permission is permanent, and the member has the corresponding use permission until the administrator deletes the member
- 2.Door opening method: the administrator can determine the type of permission the member has to open the door; if the administrator closes all the door opening permissions of the member, the user can no longer maintain his own door opening method through the app, and can only use the existing door opening method the way.

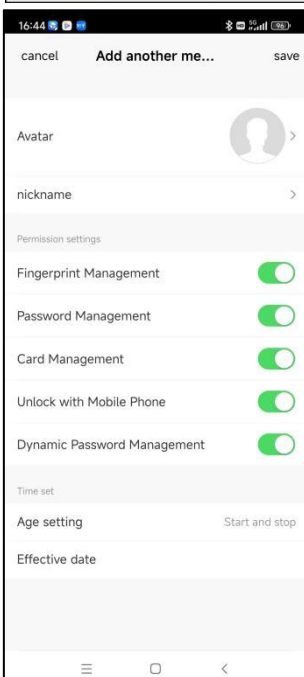

C) Other members management

1. Validity period: The administrator can determine the length of the validity period for other members. It can be set to be permanently effective, or a specified start time-end time can be set.
- 2.Door opening method. The administrator can determine the type of permission for the member to open the door;(Same as family members) .
- 3.After creating another member, the administrator can associate the member with a user of the app through the "share"operation. When the user's specified end time is reached, the user's app will automatically lose the device.

6.5.2.Opening record

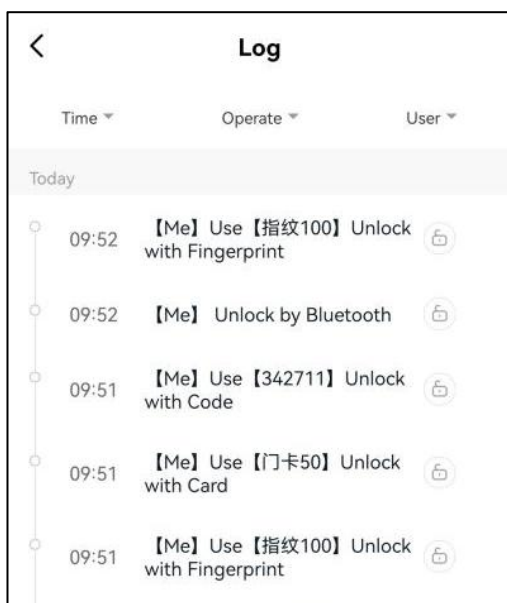

- 1.You can check the door locks and the operation record of the door lock here.
- 2.You can also inquire records by screening users, time, operation types, etc.
- 3.If the gateway is not connected, this record will not be updated in real time. Only when the APP is connected to the door lock through the Bluetooth.

6.5.3 Set unlock mode

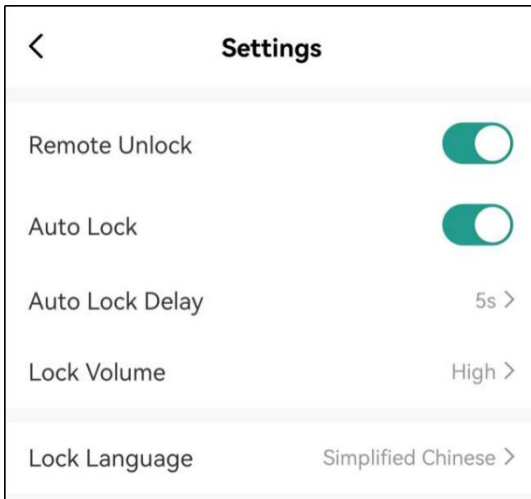

- 1.Remote Unlocking:After closing, it will not support remote unlocking.
- 2.Auto Lock:After closing, the lock is unanimously kept open , “passage mode” .
- 3.Auto Lock Delay: Set automatic locking time according to actual needs.
- 4.Lock Volume: Switch the volume of the door lock.
- 5.Lock Language: Switch the door lock navigation prompt sound.

6.5.4.Fingerprint 、 Password and Card management

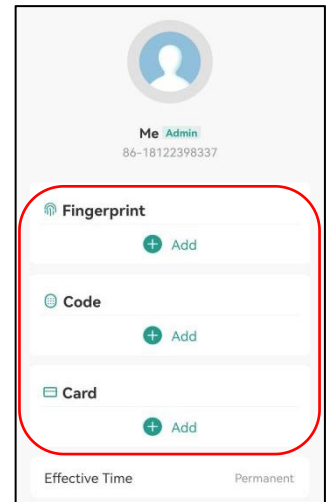
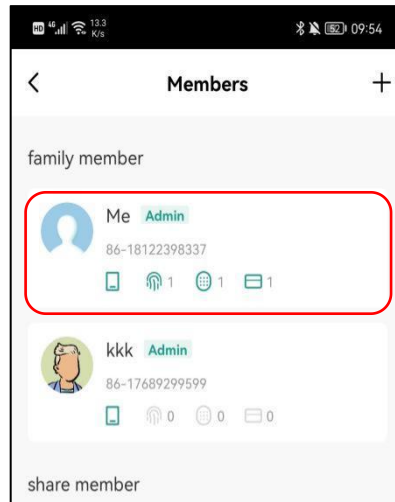
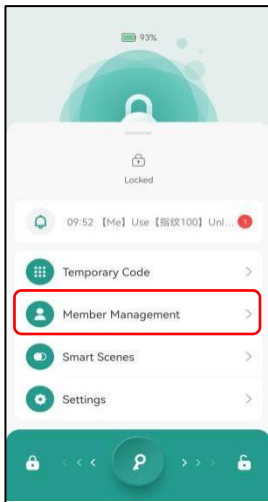

1.Connect the door lock through the app Bluetooth, the administrator can add different ways to open door for himself or other family members; before adding the fingerprint 、 password 、 card, Choose users who need to be added.

2.If you connect to the gateway, you can add these door opening methods remotely when locking online.

6.5.6 Temporary Code management

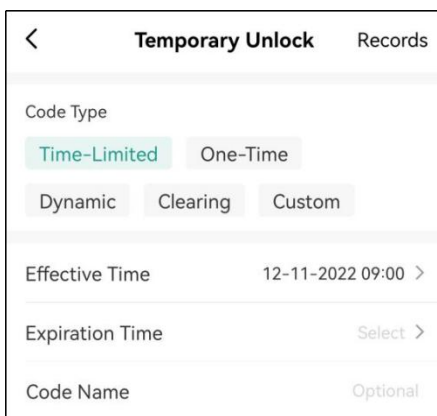

Limited time password: one algorithm password, valid time period password, must be used once every 24 hours.

- Clear all: Local input and use, the limited time algorithm password is empty, use within 24H!
- Clear a single: Local input and use it to clear the time -limited algorithm password used!
- Single password: only once in six hours.

6.6.Add gateway(option)

6.6.1.Add bluetooth Gateway

1.Electrify the gateway.The phone turns on Bluetooth and connects to 2.4g Wi-Fi (note that if the router supports both 2.4g and 5G modes, the phone must be connected to a 2.4g network; 2.4g and 5G hybrid modes are not supported).

2.After the gateway is powered on and stable, confirm that the distribution network indicator light (blue light) is in the state of blue.If the indicator is in other state, long press the reset button near the power jack until the blue light is always on. The positions of the indicator and the button are as shown in the picture.

3. Click the "Add Device" button or the "+" in the upper right corner -- "Select device type" gateway and Others "--" Wireless Gateway (Bluetooth) ", as shown in picture 1.

4. As shown in picture 2, reset the device according to the prompt, confirm that the red indicator flashes, search for the device according to the prompt and complete the addition (as shown in picture 3, 4 and 5).

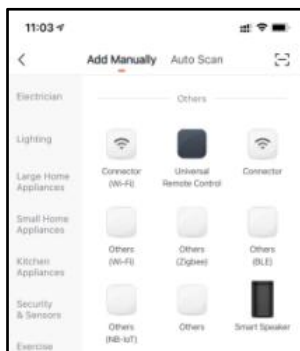
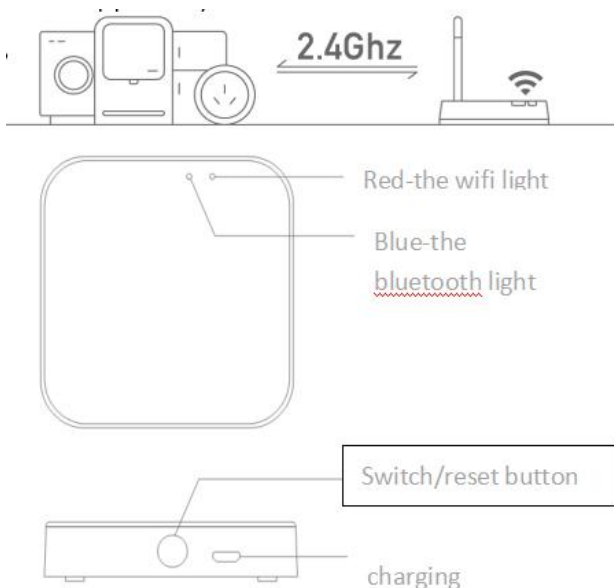

1

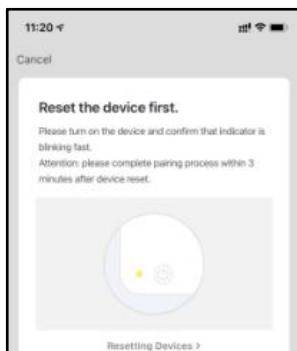

2

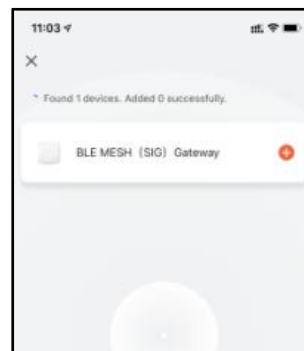

3

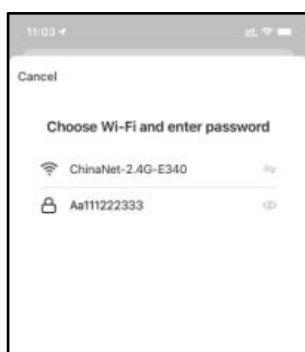

4

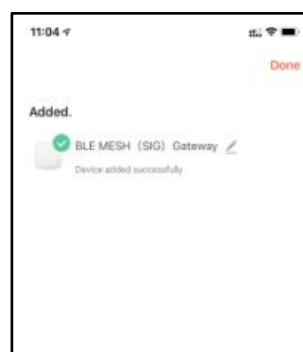

5

6.6.2.Add door lock to the Bluetooth gateway

There are two ways to add bluetooth door lock device under bluetooth gateway:

Method 1: Enter the Bluetooth Gateway Device APP panel (as shown in picture 1), select add in the list, and jump to the list of Bluetooth door lock devices that have been added (as shown in picture 2);

Method 2: Select the new device to search, select the "door lock" sub-device (as shown in picture 3), and start the bluetooth door lock distribution network process



1



2

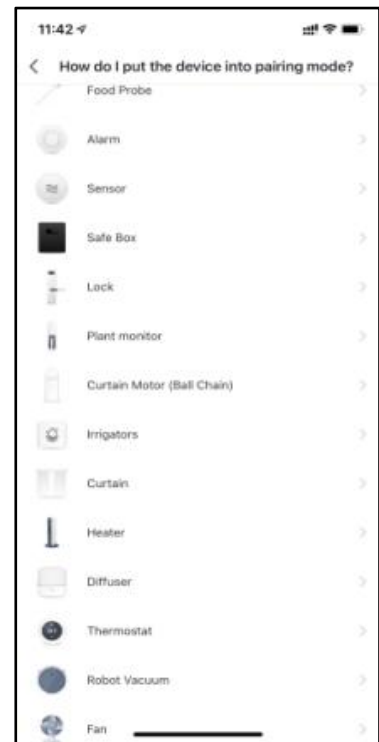

3

Note :

1. The lock can be opened using default code 123456 followed by # in trial mode
2. When the voltage is lower than 4.6V, the lock will automatically alarm every time. After the alarm, the lock can be unlocked for 200 times. After the number of times, the delay time of each lock opening will be 2 seconds.

7.Reset the Lock

Please note all data will be erased if you reset your lock to factory default.

8. Replace Batteries

Please use 4 high-quality alkaline AA batteries for replacement when the battery is dead.

9.5V Emergency Power

Micro USB interface is used to connect regular 5V power bank to activate the lock in case the battery is dead.

Note: The Micro USB interface is only used for emergency unlock and cannot be used for battery charging.

10. Emergency Key Unlock

Emergency key can be used when the battery is dead.

Note: Keep at least one key outside your house so you can get it to unlock in case of emergency.

11. Keypad

The lock supports up to 16-digit Vague Code. Just enter any 16-digit code, as long as a correct code is include in what you entered, you can open the door.

12.Unlock From Outside

①Fingerprint

Place your finger on fingerprint reader to unlock.

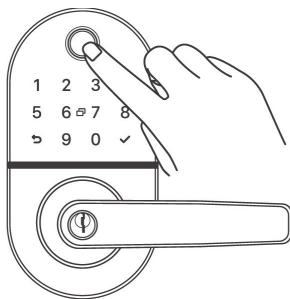

②User Code

Enter 6-9 digit code and to unlock. (You have set the unlock password in step.

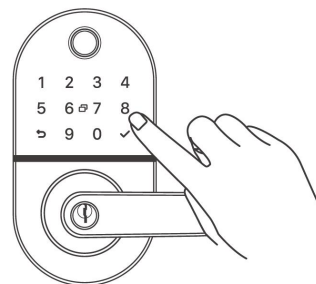

③Card

Swipe your card on the keypad of the lock to unlock.

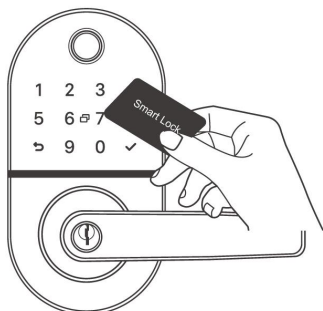

④Mechanical key

Insert the key into the lock cylinder hole and rotate it 90 degrees counterclockwise.

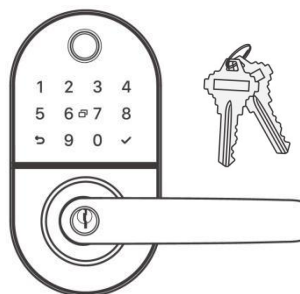

⑤Smartphone

Use your smartphone to unlock. Please refer to the guide in TTLock App

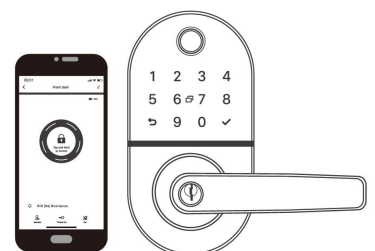

13. FAQ

1) How to read operation records?	In the Records of the main interface.
2) Why can't I unlock it after open the passage mode	You need to perform an unlock verification in any method, then the passage mode will take effect.
3) What is the purpose of Auto Lock	You can set how long to lock after unlocking
4) After installation, touch sensing keyboard, screen no respond	<ul style="list-style-type: none">a) In this case, first check that the positive and negative electrodes of the battery have been installed upside down, whether the battery has enough powerb) Remove the back panel and see if it's connectedc) To eliminate the above situation, you need to remove the lock ,check whether the wires of the lock body are squeezed, and the re-wire
5) Unable to register fingerprint	<p>Check the fingers for dirt or wear, check the fingerprint head on the lock for dirt and oil stains, etc.</p> <p>Check to see if the fingerprint is working properly(Press to see if there is any responds.</p>
6) What is the reason why the smart lock consumes fast power?	<ul style="list-style-type: none">a) Large standby power consumptionb) Short circuit
7) There is no response to pressing the handle on outside the door, and there is unlock normally on inside the door, but the verification is normal, and the motor is normal.	It may be the triangle direction on the clutch was error, please check correction.
8) How many times will the password be locked? How long is it locked?	Enter the wrong password more than 5 times in a row, the keyboard is locked for 90 seconds

Guarantee

Customer Name: _____

Customer Calls : _____

Purchase Date : _____

Product Name : _____

Product Model : _____

Note:

- ① Please keep this card so that you can use it when you need warranty service.
- ② We provide you with a one-year warranty from the date of purchase.
- ③ This warranty service is valid for customers in any country in the world.